

instruction manual

hanging lamp n°5

valerie_objects

V9015032MD (brass) / V9015032BD / V9015032GD / V9015032ID / V9015032ZD / V9022032RD

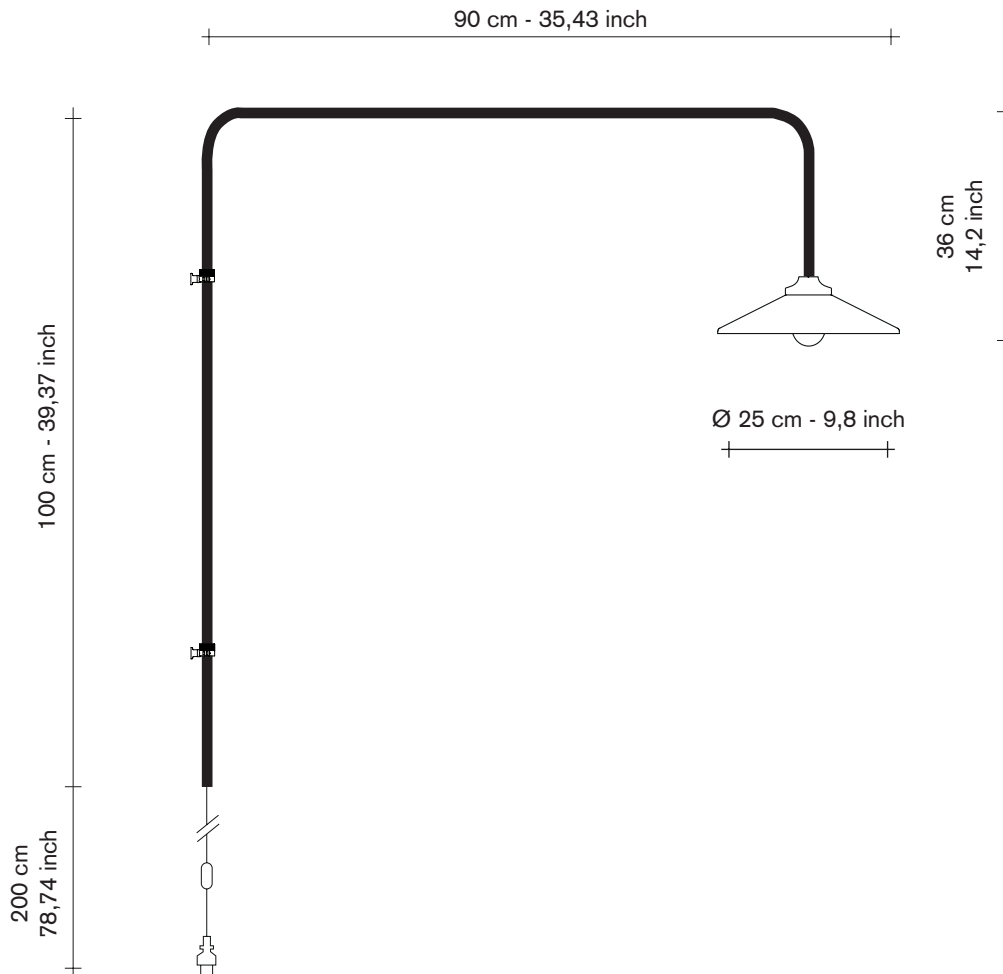

for indoor use only, where direct contact with water is impossible



the armature can be used in combination with a dimmer. consult the sales outlet for the correct type



protection class 1:
the fitting must be earthed



this luminaire was designed to work only with the indicated voltage



the maximum wattage indicated in each lighting unit, for example, must not be exceeded



observe the indicated minimum distance between the lamp and the illuminated materials/objects



not to be disposed with domestic waste in rubbish bin, bring it to a staging area for electrical waste

This product contains a light source of energy efficiency class F.

safety directions

Please study the instruction manual carefully before installing or using this product. Keep this user manual for further reference / two persons needed for installation.

1. The luminaires may only be installed by authorized and qualified technicians according valid regulations for electrical installation.
2. Maintenance of the luminaires is limited to their surfaces. During maintenance no moisture can come into contact with any areas of the terminal connections or voltage control parts.
3. Take account of the minimal separation distance from other objects and the room required around the fitting.
4. If in any doubt, consult a professional, taking local installation requirements into account. Some countries stipulate that lighting may be installed only by registered installers.
5. When replacing a lamp, wait for it to cool, for a minimum of 5 minutes.
6. Clean with a clean, dry cloth or brush, use no solvents or abrasives. Avoid dampness on all electrical components.
7. Take account of all available technical information.
8. If the external exible cable or cord of this luminaire is damaged, it shall be exclusively replaced by the manufacturer or his service agent or a similar qualified person in order to avoid a hazard.

1x hanging lamp
(frame + power cord)

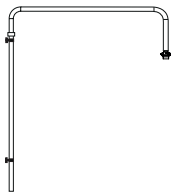

2x set wall brackets
(wall plugs included)

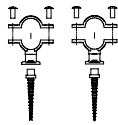

1x lamp shade

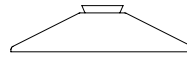

1x LED bulb silvered cap
4W - 350 lm
2700K (dimmable)
energy class A+



We recommend 2 persons to install the wall lamp

1. Assemble the two back parts of the wall bracket

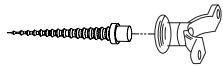

2. Drill two holes with the requested diameter for the appropriate wall plugs according your type of wall

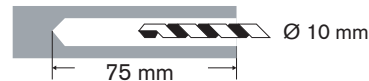

3. Screw the back part of wall bracket into the wall plug (by hand)



4. Positioning of base part
(second person holds the upper part)
Screw careful the front part of the wall bracket on its backpart. The base part of the lamp fixture fits into the two brackets. The upper ring rests on the upper wall bracket. *Recommended to tighten the brackets by hand.

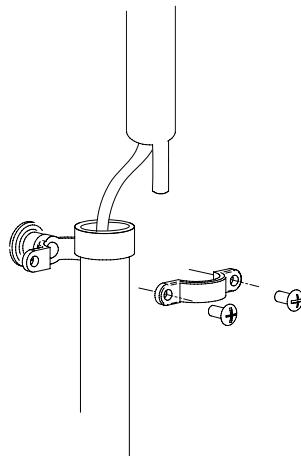

5. Positioning of top part

Person one > the cable coming out of the top part, has to be inserted into the base part of the light fixture.
Second person > take care and pull gently on the cable at the outlet below.

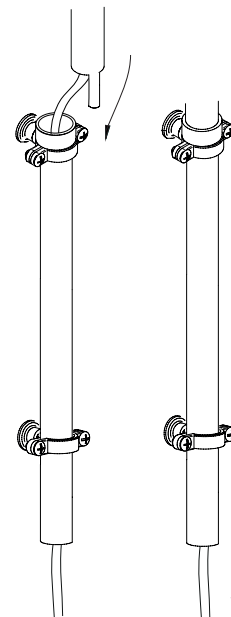

Pull precisely and with caution at the power cord to ensure a tight fitting of the two lamp parts

1.

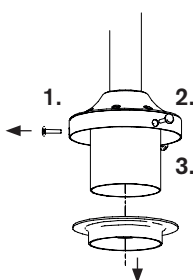

2.

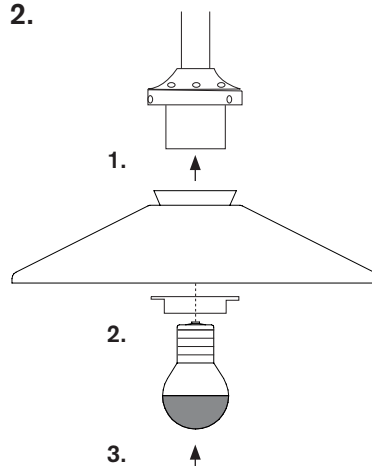

3.

